



3351 Commerce Parkway

former Hytera space

Equidistant from Ft. Lauderdale and Miami, Miramar Park of Commerce is a light industrial park campus in Southwest Broward County fronting the Florida Turnpike just one mile east of the Red Road Interchange.

Since breaking ground in 1984, Sunbeam has developed the Miramar Park of Commerce into South Florida's largest locally-owned and managed Business Park, with over five million square feet of office/service, laboratory, pharmacy, light manufacturing and distribution space.

The world class park is home to 10,000 employees from more than 170 national and international companies. New flex/office space, corporate build-to-suits as well as a limited number of second-generation spaces are available in the park.

± 7,301 SF Flex space
Available May 2019

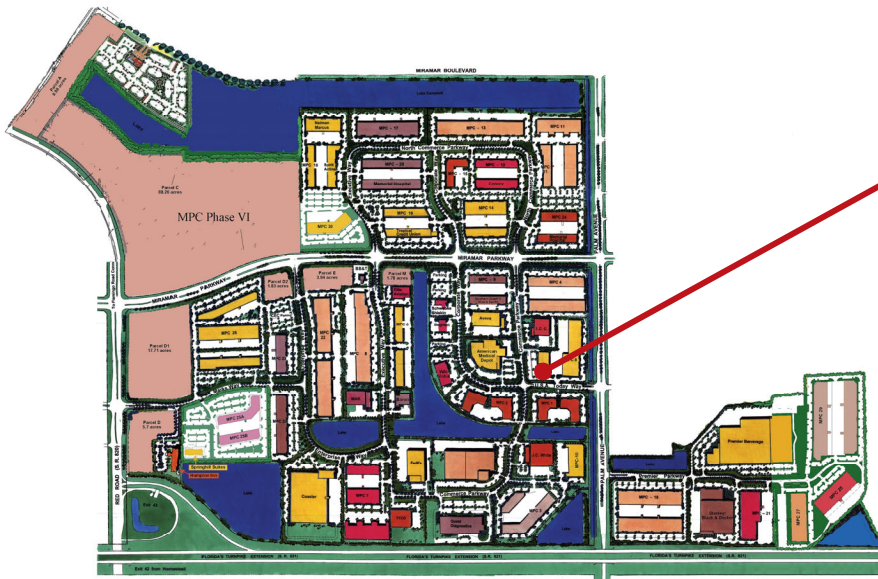

Ryan Goggins
Vice President
+1 954 652 4613
ryan.goggins@colliers.com

Jonathan Kingsley
Executive Vice President
+1 954 652 4610
jonathan.kingsley@colliers.com

Ilyssa Shacter
Associate | South Florida
+1 954 652 4624
ilyssa.shacter@colliers.com

Copyright © 2018 Colliers International. Information herein has been obtained from sources deemed reliable, however its accuracy cannot be guaranteed. The user is required to conduct their own due diligence and verification.

3351 Commerce Parkway

former Hytera space



± 7,301 SF Flex space
Available May 2019

www.miramarflexspace.com

- ± 7,301 SF Total
- ± 5,696 SF Office
- ± 1,605 SF Warehouse
- Dock High
- 18' Clear Height
- 4:1,000 Parking
- More parking can be made available
- Available May 2019
- Asking Rate: \$11.25 PSF NNN

